

®

STUBAI



PRODUCTS 2013/14
M O U N T A I N E E R I N G





INTRO

For outdoors enthusiasts and mountain sportsmen, the reliability of our equipment plays a major part in being able to use it safely. The magnetic attraction we feel towards Mother Nature can only exist if we have absolute trust in our equipment.

At STUBAI, we use the latest manufacturing techniques, the best materials, constant quality controls, and not least, all of our 115+ years of experience to ensure that our products have become valued companions for so many mountain sports lovers, and will continue to do so for many more.

Our core values of Innovation, Quality and Safety are underlined by our passionate team of experienced climbers, mountaineers and engineers, who are constantly testing, improving and expanding our range. We have tested our equipment all over the world, but we have the great privilege of being able to do most of our testing in our own back yard – amongst the glorious peaks and glaciers of the Stubai Alps.

We consider it our duty to the many thousands of you all over the world, who depend on our STUBAI products every day, to stay true to our values and to always seek to improve on your behalf.

Your Stubai Team

QUALITY MADE IN TYROL/AUSTRIA - SINCE 1897!





CONTENT

- 5 QUICKDRAWS
- 6-8 KARABINERS
- 8 VIA FERRATA SETS
- 8 CANYONING SLINGS
- 9 HELMETS
- 10 CLIMBING HARNESSSES
- 11 BELAY DEVICES
- 12 SLINGS
- 12 CHALK
- 13 MOUNTAINEERING ACCESSORIES
- 14 PACKS / BAGS
- 15-16 PITONS / HANGERS
- 17-18 CRAMPONS
- 19 CRAMPON ACCESSORIES
- 20-21 ICE AXES
- 22 ICE TOOLS
- 23 ICE AXE / ICE TOOL ACCESSORIES
- 23 ICE SCREWS
- 24-25 AVALANCHE SAFETY
- 26-27 STEEL KARABINERS
- 27-28 APPAREL
- 29 SKYSPORTS / BUCKLES
- 30 SPACE CLIP





Daniel „Dalton“ Horvath, Marjan-Split/Croatia, Route U2. Pic: Christian „Stoanmandl“ Steinlechner.

QUICKDRAWS

ANTISLIDE-SYSTEM EASYLOCK-SYSTEM

STUBAI®

Quickdraw-sets with the STUBAI ANTISLIDE slings have 2 big advantages – they are even safer, and even quicker to clip! Because the rubber ring at the bottom is sewn in to the sling, the rope karabiner is always held true, so there's no twisting. You always know that the karabiner is working to its maximum potential. This stable connection is also great when you are securing, as the crab can't slip, making clipping quicker and easier. For the best possible protection, all our karabiners have anodized coatings. The different colours on the top- and rope-karabiners help to avoid clipping rope confusion, which could snag and damage it.

ICE CLIP SET



Lightweight set with super-strong karabiners. The wire gate prevents annoying freezing in cold, wet conditions and thanks to its dimensions there is less slack and less danger of a gate being forced open. Top- and rope-karabiner with grooved back, whose different colours prevent clipping confusion. With standard-polyamid sling (16 mm width) or dyneema sling (12 mm width).

◇ 30 kN ◇ 8 kN ⤵ 10 kN
Weight 100 g (for 110 mm standard), 95 g (for 110 mm Dyneema)

Art. 979020	ICE CLIP quickdraw-set, anod., standard Antislide	110 mm
Art. 979023	ICE CLIP quickdraw-set, anod., standard Antislide	160 mm
Art. 979025	ICE CLIP quickdraw-set, anod., standard Antislide	210 mm
Art. 979030	ICE CLIP quickdraw-set, anod., Dyneema Antislide	110 mm
Art. 979033	ICE CLIP quickdraw-set, anod., Dyneema Antislide	160 mm
Art. 979035	ICE CLIP quickdraw-set, anod., Dyneema Antislide	210 mm

ROCK CLIP SET



Top of the range set with nose-free Easylock-system and high breaking strain (10 kN even with the gate open)! The different anodized colours help to avoid clipping mistakes which can snag a rope and damage it. The bent gate on the rope-karabiner and the grooved back ensure perfect handling. With standard-polyamid sling (16 mm width) or dyneema sling (12 mm width).

◇ 26 kN ◇ 8 kN ⤵ 10 kN
Weight 110 g (for 110 mm standard), 105 g (for 110 mm Dyneema)

Art. 979320	ROCK CLIP EL quickdraw-s., anod., standard Antislide	110 mm
Art. 979323	ROCK CLIP EL quickdraw-s., anod., standard Antislide	160 mm
Art. 979325	ROCK CLIP EL quickdraw-s., anod., standard Antislide	210 mm
Art. 979330	ROCK CLIP EL quickdraw-s., anod., Dyneema Antislide	110 mm
Art. 979333	ROCK CLIP EL quickdraw-s., anod., Dyneema Antislide	160 mm
Art. 979335	ROCK CLIP EL quickdraw-s., anod., Dyneema Antislide	210 mm

ICE-ROCK SET



Combines the advantages of both types of karabiner. The nose-free Rock Clip on top, the Ice Clip as the rope-karabiner which lessens both slack and the risk of a gate being forced open if you hit the wall. The bent gate on the rope-karabiner and the grooved back ensure perfect handling. With standard-polyamid sling (16 mm width) or dyneema sling (12 mm width).

◇ 26 kN ◇ 8 kN ⤵ 10 kN (Top)
◇ 30 kN ◇ 8 kN ⤵ 10 kN (Rope)
Weight 105 g (for 110 mm standard), 100 g (for 110 mm Dyneema)

Art. 979910	ICE-ROCK CLIP quickdraw-s., anod., standard Antislide	110 mm
Art. 979913	ICE-ROCK CLIP quickdraw-s., anod., standard Antislide	160 mm
Art. 979915	ICE-ROCK CLIP quickdraw-s., anod., standard Antislide	210 mm
Art. 979810	ICE-ROCK CLIP quickdraw-set, anod., Dyneema Antislide	110 mm
Art. 979813	ICE-ROCK CLIP quickdraw-set, anod., Dyneema Antislide	160 mm
Art. 979815	ICE-ROCK CLIP quickdraw-set, anod., Dyneema Antislide	210 mm

ROCK CLIP INDOOR SET



Specialist indoor-climbing set consisting of our aluminium Rock Clip Easylock karabiner (Art. 974210), standard Antislide 110 mm sling (Art. 950111) and a steel quick-link Rapid with screw.

Weight 195 g

Art. 979701	ROCK CLIP Indoorclimbing-set, anod., standard Antislide	110 mm
-------------	---	--------



KARABINERS

STUBAI offers a specially designed range of karabiners with various forms and locking systems. Our use of finest grade materials and the most modern technology guarantees the highest possible quality of our products. All our karabiners have anodized coatings!

STUBAI®



EASYLOCK-SYSTEM



ICE CLIP

The ICE CLIP is a great value lightweight high strength karabiner. The wire gate prevents potential icing in freezing wet conditions.

◇ 30 kN ◇ 8 kN ⤵ 10 kN ⤵ 28 mm (bent gate) ⤵ 26 mm (straight gate)
 Weight 43 g
 Exterior dimensions 101 x 56 mm

Art. 975010	ICE CLIP karab., straight gate, anod.	30 kN
Art. 975510	ICE CLIP karab., bent gate, anod.	30 kN

ROCK CLIP

Reliable and rigorously-tested karabiner!
 Sold with EASYLOCK-system (nose-free).

◇ 26 kN ◇ 8 kN ⤵ 10 kN ⤵ 21 mm (bent gate) ⤵ 19 mm (straight gate)
 Weight 46 g
 Exterior dimensions 101 x 56 mm

Art. 974200	ROCK CLIP Easylock karab., straight gate, anod.	26 kN
Art. 974210	ROCK CLIP Easylock karab., bent gate, anod.	26 kN

ATOMY

Weighing in at just 60 g, our ATOMY is one of the world's lightest screw-gate karabiners. We could have gone even lighter with an aluminium castor, but we couldn't compromise on the top performance of brass. In a 26 kN Norm breaking strain test, this model cleans up against other karabiners in the same class. Nothing as light and small can touch the strength of the ATOMY.

◇ 26 kN ◇ 8 kN ⤵ 10 kN ⤵ 16 mm
 Weight 60 g
 Exterior dimensions 101 x 56 mm

Art. 974285	ATOMY Easylock karab., w. screw gate, anod.	26 kN
-------------	---	-------

HMS PICO

The STUBAI HMS PICO is a full-blooded HMS karabiner which belies its size. The specially designed contours particularly lend it to use with modern thin ropes and the munter hitch (HMS). The PICO has already made a name for itself as a belay karabiner combining perfectly with the Stubai Tuber, Figure 8 and other belay devices. For alpine climbing, where every gramme counts, it can be used as the main belay karabiner. As you would expect of us at STUBAI, the screw is high quality brass to ensure it keeps working as good as new for years and years (it helps if it's kept clean and given a drop of oil occasionally). With the STUBAI PICO, (Latin for small, and portuguese for peak!) the name already says it all!

◇ 21 kN ◇ 8 kN ⤵ 7 kN ⤵ 20 mm
 Weight 59 g
 Exterior dimensions 97 x 65 mm

Art. 977785	HMS PICO Easylock, w. screw gate, anod.	21 kN
-------------	---	-------

HMS 3D

The unique STUBAI HMS 3D! Its special shape prevents a running rope from touching the rock-face, regardless of the position of the karabiner.

◇ 22 kN ◇ 8 kN ⤵ 6 kN ⤵ 26 mm
 Weight 96 g
 Exterior dimensions 110 x 71 mm

Art. 977761	HMS 3D karab., w. screw gate, anodized	22 kN
-------------	--	-------



HMS PRO

The HMS screw-gate karabiner remains our most popular safety device. The brass screw over the precisely engineered thread guarantees reliability and easy handling. The eye-catching red anodized finish makes it especially useful as a central karabiner, and makes it more durable. With its easylock system, clipping in and out is easier than ever!

◇ 25 kN ◇ 11 kN ⤵ 8 kN ⤴ 23 mm
Weight 98 g
Exterior dimensions 115 x 73 mm

Art. 977781	HMS PRO Easylock karab., w. screw gate, anod.	25 kN
Art. 977742	HMS PRO Easylock, w. screw, compl. black anod.	25 kN



HMS PRO TWISTLOCK

The Twistlock system is a self-locking gate which opens with a simple 90 degree twist.

◇ 24 kN ◇ 11 kN ⤵ 7 kN ⤴ 22 mm
Weight 113 g
Exterior dimensions 115 x 73 mm

Art. 977731	HMS PRO Twistlock karab., anodized	24 kN
-------------	------------------------------------	-------



HMS PRO PUSH & TWIST

The Push & Twist system provides an extra level of safety. The karabiner can only be opened with a 90 degree twist if the barrel has been pushed up.

◇ 24 kN ◇ 11 kN ⤵ 7 kN ⤴ 21 mm
Weight 116 g
Exterior dimensions 115 x 73 mm

Art. 977799	HMS PRO Push & Twist karab., anodized	24 kN
-------------	---------------------------------------	-------



ALPHA PRO

The Alpha Pro with screwgate is a versatile karabiner with high strength and wide gate clearance.

◇ 30 kN ◇ 10 kN ⤵ 12 kN ⤴ 22 mm
Weight 99 g
Exterior dimensions 113 x 72 mm

Art. 977511	ALPHA PRO karab., w. screw gate, anod.	30 kN
-------------	--	-------



ALPHA PRO TWISTLOCK

The Twistlock system is a self-locking gate which opens with a simple 90 degree twist.

◇ 30 kN ◇ 10 kN ⤵ 12 kN ⤴ 23 mm
Weight 109 g
Exterior dimensions 113 x 72 mm

Art. 977531	ALPHA PRO Twistlock karab., anodized	30 kN
-------------	--------------------------------------	-------



ALPHA PRO PUSH & TWIST

The Push & Twist system is for extra security. The karabiner can only be opened with a twist if the barrel has been pushed up.

◇ 30 kN ◇ 10 kN ⤵ 12 kN ⤴ 22 mm
Weight 116 g
Exterior dimensions 113 x 72 mm

Art. 977599	ALPHA PRO Push&Twist karab., anodized	30 kN
-------------	---------------------------------------	-------



YPSILON 3600

The Ypsilon 3600 with screwgate is the strongest aluminium karabiner in the STUBAI range. For situations where you need that extra strength. With its easylock system, clipping in and out is easier than ever.

◇ 36 kN ◇ 10 kN ↻ 14 kN ↻ 18 mm

Weight 98 g

Exterior dimensions 113 x 62 mm

Art. 973021	YPSILON 3600 EL karab., w. screw gate, anod.	36 kN
-------------	--	-------

FERRATA CONNECT

Modern, easy to use karabiner for use on via ferrata. The palm clip system of the Ferrata Connect can be easily engaged even by children. We have set the gate down in the corner of the karabiner for extra large gate clearance.

◇ 32 kN ↻ 14 kN ↻ 26 mm

Weight 120 g

Exterior dimensions 135 x 77 mm

Art. 977553	FERRATA CONNECT karab., anodized	32 kN
-------------	----------------------------------	-------

VIA FERRATA SETS

STUBAI®

CONNECT COMPACT TUBE

Y-shaped Ferrata set with a sewn-in shock absorber which offers controlled braking even in difficult circumstances (like wet conditions). The absorber's compact carry-bag can be quickly opened for inspection. The stretchy elasticated arms also stop that annoying tangling. The tried and tested palm clip karabiners with large gate clearance of 26 mm make clipping simple and effortless. The newly designed karabiner arms are built for strength, and in tests, comfortably exceed the values required by the newest regulations.

A VIA FERRATA GUIDE for the STUBAI valley including all the best ferrata routes in our beautiful valley is included (in German) as standard.

Weight 465 g

Art. 988472	CONNECT COMPACT TUBE via ferrata set	465 g
-------------	--------------------------------------	-------

INCL. GUIDE
STUBAI VALLEY



CANYONING SLINGS

STUBAI®

CANYONING CONNECT

STUBAI CONNECTOR in Y-Form with FERRATA CONNECT karabiner complying with EN 354. Designed for use in canyoning.

Art. 988490	CANYONING CONNECT Set	365 g
-------------	-----------------------	-------

Art. 988492	CANYONING DYNEEMA CONNECT Set	285 g
-------------	-------------------------------	-------



HELMETS

**FUSE LIGHT**

A light but robust moulded helmet which combines comfort with effectiveness. Size can be changed in seconds with the adjuster wheel, even with one hand. It has great ventilation, and padding both inside of the helmet and on the adjustable chin-strap. The ergonomic neck-line completes the Fuse Light's features, and its shape ensures perfect field of vision at all times – even when looking up. Also equipped with a handy headlamp holder.

Size 54-62 cm [XS-XL] / Weight 350 g

Art. 900005	FUSE LIGHT climbing helmet, white	350 g
Art. 900006	FUSE LIGHT climbing helmet, red	350 g

**NIMBUS**

The STUBAI NIMBUS (latin for Halo) is a state of the art, ultralight climbing helmet! Thanks to the use of polycarbonate and In-Mould technology the NIMBUS weighs 240 grams only. Its low weight and perfect shape means you could almost forget you are wearing it. The NIMBUS has an adjustable chin-strap, and a simple adjuster wheel for a perfect fit. With good ventilation and a headlamp holder, it is equally useful in the heat of the day or the dark of the night.

Size 54-62 cm [XS-XL] / Weight 240 g

Art. 900016	NIMBUS climbing helmet, red	240 g
-------------	-----------------------------	-------

**DELIGHT JUNIOR**

The STUBAI DELIGHT JUNIOR is a climbing helmet with a robust ABS outer shell, designed specially for smaller heads. With a wheel at the back and an adjustable and padded chin strap, you can change the fit quickly with just one hand. There are eight openings for ventilation, and the padded inner lining is made from sweat absorbant material for optimal comfort. The ergonomic neck-line means perfect field of vision at all times - even when looking up. The adjustment range from 48 to 57 cm is perfect for kids but also for teenagers and adults with smaller heads!

Size 48-57 cm / Weight 340 g

Art. 900008	DELIGHT JUNIOR kids climbing helmet	340 g
-------------	-------------------------------------	-------



CLIMBING HARNESSES

STUBAI®

Full harnesses (chest-waist combinations) prevent the wearer from tipping backwards in the event of a fall, and are aimed primarily at rucksack wearers. Since the majority of falls occur whilst sport climbing, our sports harnesses are padded in the hip and thigh area. We know mountaineers need more equipment, so we have armed their harnesses with more gear loops.



SCALE

The STUBAI SCALE waist harness is the best choice for ski-tourers, glacier-tourers and mountaineers. Because it is so light and compact, (only 250g size XS-M) you can always take it with you – even when it might not be needed. Better safe than sorry! The un-padded waist belt is perfect with thicker clothing and doesn't get in the way of a rucksack. A classic double-back fastener on the waist belt and clip fasteners on the legs mean it can be put on or off quickly in any situation. Skis and crampons can stay attached! There are two generous gear loops for all your equipment – and we reckon it looks pretty tasty too!

Weight 250 g (XS-M), 280 g (M-XL)

Art. 998016	SCALE waist harness	XS-M
Art. 998017	SCALE waist harness	M-XL



VARIO

Low volume and weight make this an ideal harness for mountaineering, glacier touring or via ferrata tours. On the gear loop there is enough room for extra kit, and all straps are adjustable.

Weight 310 g

Art. 998022	VARIO waist harness	310 g
-------------	---------------------	-------



UTILITY

A general purpose adjustable chest harness. The UTILITY is compatible with any waist harnesses. CAUTION: Never wear a UTILITY chest harness on its own!

Weight 205 g

Art. 998018	UTILITY chest harness	205 g
-------------	-----------------------	-------



COMBI

The Combi is a very comfortable and easily adjustable harness combination, developed specially for via ferrata use. As you do not need so much gear on a via ferrata, this harness only requires two loops.

Weight 590 g

Art. 998025	COMBI full body harness	590 g
-------------	-------------------------	-------

TRIPLE

The STUBAI TRIPLE is a fully adjustable, really easy to wear, but also extremely light sport climbing harness. With the 3 Fastfix buckles on the waist belt and on both leg loops, you can forget slow and fiddly threading. With the drawstrap, the tie-in point can be centred with speed and ease. That makes this rig ideal for both rentals and for year-round users, who are on the rock and ice in a variety of thickness of clothing. Weighing in at just 365 grammes, this is a champion amongst bantam-weight fully adjustable padded harnesses. The ergonomic cut, and the breathable mesh material guarantee an exceptional level of comfort.

Size adjustment:

Waist belt: XXS-XS 54-68 cm, XS-M 65-85 cm, S-XL 75-100 cm, M-XXL 81-110 cm

Leg loops: XXS-XS 40-50 cm, XS-M 48-60 cm, S-XL 53-66 cm, M-XXL 57-66 cm

Weight 365 g (XXS-XS), 400 g (XS-M), 415 g (S-XL), 435 g (M-XXL)

Art. 998070	TRIPLE Junior sport climbing harness, adj.	XXS-XS
Art. 998068	TRIPLE sport climbing harness, adj., red-black	S-XL
Art. 998069	TRIPLE sport climbing harness, adj., grey-red	S-XL
Art. 998060	TRIPLE sport climbing harness, adj., red-black	XS-M
Art. 998066	TRIPLE sport climbing harness, adj., grey-red	M-XXL



Bergsteiger
TIPP
Allround

04-2013

PREISTIPP
2-3/10
Klettern

BELAY DEVICES



STANDARD

This large figure of eight is great for smooth descents and dynamic belay. The STANDARD is made from anodized forged aluminium.

Strength 30 kN
Weight 109 g
Length 145 mm

Art. 988125	STANDARD figure of eight, anodized, red	30 kN
Art. 988126	STANDARD figure of eight, anodized, black	30 kN



BC PRO

The STUBAI BC PRO is a lightweight and compact belay/rappel device, with grooved V-shaped brake notches. This forged aluminium Tuber can be used in two ways – either for high friction on the grooved side, or for fluent running on the opposite, smooth side. The rope feed is optimal in either. The BC PRO reduces rope-wear and prevents annoying kinking.

Recommended rope dimensions:
Half- or twin rope from 7,7-9,5 mm
Single rope 8,9-11 mm

Weight 62 g

Art. 988131	BC PRO belay device	62 g
-------------	---------------------	------



BC

Classic belay with excellent braking ability, especially when used with adouble or twin rope. Great for abseiling as it keeps the two ropestrands apart.

Weight 55 g

Art. 988130	BC belay device	55 g
-------------	-----------------	------



BELAY PLUS

A safety set consisting of our HMS PRO karabiner with screw-gate and the STUBAI BC. This combination is ideal for dynamic belay and can also be used for abseiling.

Weight 150 g

Art. S9000SET61	BELAY PLUS safety set, 2-pcs	150 g
-----------------	------------------------------	-------



BC PRO SET

A safety set consisting of our STUBAI HMS PRO karabiner with screw-gate (Art. 977781) and the tuber STUBAI BC PRO (Art. 988131). For dynamic belay and for abseiling.

Weight 157 g

Art. S9000SET62	BC PRO safety set, 2-pcs	157 g
-----------------	--------------------------	-------



BC PICO SET

A safety set consisting of our small and light STUBAI HMS PICO karabiner with screwgate (Art. 977785) and the tuber STUBAI BC PRO (Art. 988131).

Weight 122 g

Art. S9000SET65	BC PICO safety set, 2-pcs	122 g
-----------------	---------------------------	-------

SLINGS

STUBAI®



ANTISLIDE-SYSTEM

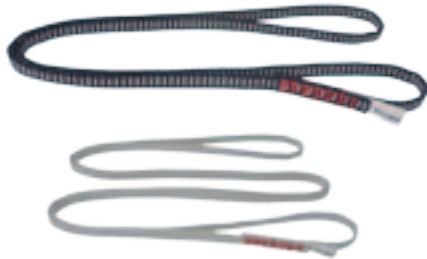

CIRCLE

The STUBAI CIRCLE is a stitched sling made from high quality tubular webbing. By weaving in Dyneema strands we have easily met the breaking strain norm despite a width of just 10 mm. Additionally, the STUBAI CIRCLE slings are markedly lighter, thinner and more flexible than normal nylon models. Strength 22 kN. Fabric Polyamid tubular webbing. Width 10 mm. Weight 29 g (60 cm), 56 g (120 cm)

Art. 950241	CIRCLE sling Dyneema 10 mm	L 60 cm
Art. 950251	CIRCLE sling Dyneema 10 mm	L 120 cm

ANTISLIDE

The STUBAI ANTISLIDE-slings have 2 big advantages – they are even safer and even quicker to clip! Because the rubber ring at the bottom is sewn in to the sling, the rope karabiner is always held true, so there's no twisting.

Strength 22 kN. Fabric Polyamid tubular webbing. Width 12 + 16 mm. Weight 17 g (Standard), 12 g (Dyneema).

Art. 950111	ANTISLIDE quickdraw standard 16 mm	L 11 cm
Art. 950211	ANTISLIDE quickdraw Dyneema 12 mm	L 11 cm

INDOOR ANTISLIDE

The new STUBAI INDOOR ANTISLIDE is a fully stitched sling, with a built-in antislid rubber ring. The extra stitches make the sling more stable, more rigid and the karabiners are held true. They also mean that a climber can't use the sling as a foot or hand hold, both of which can increase the chance of a fall and serious injury.

Strength 22 kN. Fabric Polyamid tubular webbing. Width 16 mm. Weight 23 g (20 cm), 31 g (30 cm), 43 g (45 cm), 56 g (60 cm).

Art. 950120	INDOOR ANTISLIDE quickdraw standard 16 mm	L 20 cm
Art. 950130	INDOOR ANTISLIDE quickdraw standard 16 mm	L 30 cm
Art. 950145	INDOOR ANTISLIDE quickdraw standard 16 mm	L 45 cm
Art. 950160	INDOOR ANTISLIDE quickdraw standard 16 mm	L 60 cm

NEW



CHALK

STUBAI MgPRO is an alkaline magnesium carbonate chalk which you can trust to keep your hands bone dry. For perfect grip both on rock and on the climbing wall. Its top quality makes it ideal for bouldering, sport or mountain climbing or, of course, strength training in the gym.

STUBAI®

MgPRO CHALKBALL 60 g

Large and long lasting Chalkball in a very fine net bag. Very low dust emission, which both your lungs and climbing partner will appreciate. Chalkballs have been mandatory in many climbing halls for a while now. Weight 60 g. Available in sets of 25 only.

Art. S950501	MgPRO Chalkball-Set	25 x 60 g
--------------	---------------------	-----------

MgPRO REFILL-CHALKBALL 60 g

Large and long lasting Chalkball in a very fine net bag. Very low dust emission, which both your lungs and climbing partner will appreciate. Chalkballs have been mandatory in many climbing halls for a while now. The net opens with a drawstring and can be filled as required.

Weight 60 g. Available in sets of 25 only.

Art. S950505	MgPRO Refill-Chalkball-Set	25 x 60 g
--------------	----------------------------	-----------

MgPRO CHALKPOWDER 350 g

Lump of white magnesium carbonate in polythene bag. For filling your chalkbag or your chalkball refill.

Weight 350 g. Available in sets of 10 only.

Art. S950510	MgPRO Chalkpowder-Set	10 x 350 g
--------------	-----------------------	------------



MOUNTAINEERING ACCESSORIES



FLEX-BALLS

The STUBAI FLEX-BALLS training balls are great allrounders: They are mostly used for strengthening fingers and forearms, but they can also be used to improve your flexibility and even your juggling skills! Great for warming-up before climbing or simply for stress-relief!

Available in a pack of 3 x 30 g balls
Diameter Ø 7 cm

Art. 950020	FLEX-BALLS training balls, 3 pcs á 30 g	Ø 7 cm
-------------	---	--------

EASY PULL

The EASY PULL is a handy little swivel roller for reducing friction when using pulleys or hauling. For use with ropes up to 11 mm diameter.
CAUTION: Do not use for lifting people. For use as deflection pulley only!

Strength 12 kN
Weight 40 g

Art. 988501	EASY PULL rope pulley, swivel	12 kN
-------------	-------------------------------	-------

ATTACH

Our multi-purpose mini-karabiner. For use as anything from a hanger for your hammer to a key ring.
CAUTION: Not for climbing use!

Dimensions 63 x 32 mm
Weight 10 g

Art. 977912	ATTACH EL mini-karabiner, red	1,0 kN
Art. 977913	ATTACH EL mini-karabiner, black	1,0 kN

DWARF

Small screwgate accessory karabiner for hanging equipment.
CAUTION: Not for climbing use!

Dimensions 70 x 36 mm
Weight 19 g

Art. 977915	DWARF EL mini-karabiner, black	1,0 kN
Art. 977916	DWARF EL mini-karabiner, red	1,0 kN

ROCKY

A well-balanced hammer for knocking in pitons or bolt hangers after drilling. It has a rubber handle and a hanging hole.

Length 30 cm
Weight 590 g

Art. 916401	ROCKY rock hammer	30 cm
-------------	-------------------	-------

PRO CAMP

Professional quality camping axe with an aluminium handle and a special extra-light hatchet which cuts into all types of wood and can even be used to fell smaller trees. Glance protector for optimal handling and finger protection. With hammer head for knocking in tent pegs etc.

Length 50 cm
Weight 790 g

Art. 672050BS	PRO CAMP Professional Camping Axe	50 cm
---------------	-----------------------------------	-------

NEW

NEW

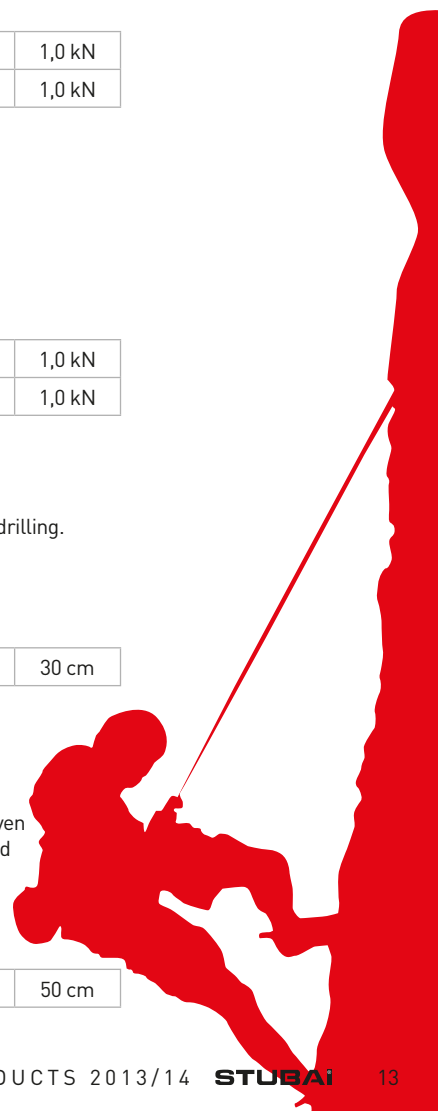

PACKS / BAGS

NEW



TECBAG EVO

We believe we have thought of everything in the design of this all-round mountain rucksack. The most important features are a built-in rain cover, attachments for snowboard, snow shoes, skis and ice axes, a headphone-socket, a removable net pocket, and an inner compartment for avalanche safety equipment etc.

Volume 25 Liter / Weight 1150 g

Art. 950002	TECBAG EVO Rucksack, 25 Liter	1150 g
-------------	-------------------------------	--------



DAYPACK 15

Light and funky multi-purpose day bag. Perfect for shorter tours, or for use as a school or sports bag.

Volume 15 Liter / Weight 640 g

Art. 950003	DAYPACK Rucksack, 15 liter	640 g
-------------	----------------------------	-------



RIPSTOP

Practical holdall made from tough Nylon-Ripstop material. Great all-round bag for anything from climbing gear to swimming stuff.

Height 380 x Width 420 x Depth 90 mm

Art. 950016	RIPSTOP carrier bag	200 g
-------------	---------------------	-------

DOME

At last a solution to an age-old problem! You might need chalk when you're climbing, but you don't need that infernal dust refusing to stay where it should in transit – namely in the bag. Current fasteners will stop enough chalk getting out to not turn everything else in your rucksack white, but not enough for you to reach in for a clean T shirt and pull a clean one out. But we have cracked it! The STUBAI DOME chalkbag comes with a built-in impermeable cover which you simply pull over the bag in transit. So now the chalk can't get out and moisture can't get in. Sorted!

Height 16 cm / Diameter opening Ø 11 cm / Weight 140 g

Art. 950011	DOME Chalkbag	140 g
Art. 950013	DOME II Chalkbag	140 g

NEW



VUVUZELA

Everyone remembers the deafening din of the vuvuzelas at the Football World Cup in South Africa. So that no one forgets in a hurry, we have also equipped our Chalkbag with one of these horns for use as an emergency alarm. A high quality neoprene lining and a user-friendly draw-string fastener keep your chalk dry and in the bag. With belt, brush holder and zipped pocket for energy-food, keys, money, etc.!

Height 15 cm / Diameter opening Ø 10,5 cm / Weight 130 g

Art. 950006	VUVUZELA Chalkbag, red-black	130 g
Art. 950008	VUVUZELA Chalkbag, white-black	130 g



GEARBAG VELCRO

The versatile STUBAI GEARBAG VELCRO bag is made for storing crampons, ice screws, spare picks, – in fact for anything with spikes which might otherwise damage a rucksack or its contents. The superstrong outer shell is light, flexible and tear-resistant. The fleece lining absorbs moisture.

Weight 95 g

Art. 950010	GEARBAG VELCRO all purpose and crampon b.	95 g
-------------	---	------

GEARBAG ZIP

A tough little bag with straps for fixing it to your rucksack. Designed to carry your crampons, ice screws, pitons and other spikes.

Weight 50 g

Art. 919008	GEARBAG ZIP all purpose and crampon bag	50 g
-------------	---	------



PITONS / HANGERS

STUBAI®

Rock Pitons have many uses, but come into their own in a crisis, such as an accident or retreat. STUBAI has been hand-forging these tools for many years. In accordance with EN 569, we have differentiated between safety pitons (S) and pitons for progressing (F).
UL = useful length.

PROFILE PITON

Highly load-resistant, slightly wedge-shaped piton for use as a leader, CrMoV-steel.

Art. 930010	PROFILE PITON, CrMoV steel UL 70 mm (F)	55 g
Art. 930013	PROFILE PITON, CrMoV steel, UL 100 mm (S)	105 g
Art. 930015	PROFILE PITON, CrMoV steel, UL 115 mm (S)	110 g

BONG

Highly load-resistant, slightly wedge-shaped piton for use as a leader, CrMoV-steel. The two holes at the front can also be used to reduce torque.

Art. 931015	BONG rock piton, CrMoV steel, UL 120 mm (S)	165 g
-------------	---	-------

DIAGONAL PITON

Head turned at 45 degrees, CrMoV-steel.

Art. 937011	DIAGONAL PITON CrMoV steel, UL 70 mm (F)	70 g
Art. 937014	DIAGONAL PITON CrMoV steel, UL 100 mm (S)	95 g
Art. 937017	DIAGONAL PITON CrMoV steel, UL 130 mm (S)	125 g

FRENCH FORM PITON

Head turned at 90 degrees. High load resistance, CrMoV-steel.

Art. 938007	FRENCH FORM PITON, CrMoV st., UL 35 mm (F)	55 g
Art. 938009	FRENCH FORM PITON, CrMoV st., UL 55 mm (F)	90 g
Art. 938011	FRENCH FORM PITON, CrMoV st., UL 75 mm (F)	110 g

FLAT-BLADE PITON

For narrow cracks – also in frozen rock. CrMoV-steel.

Art. 939255	FLAT-BLADE PITON, CrMoV steel, UL 20 mm (F)	35 g
-------------	---	------

CLIFFHANGER 3-POINT

For cracks and edges, but tape your sling to the rock to prevent it being levered out as you progress upwards.

Art. 940008	CLIFFHANGER 3-POINT, 75 mm	35 g
-------------	----------------------------	------

CLIFFHANGER ROUND

For cracks and edges, but tape your sling to the rock to prevent it being levered out as you progress upwards.

Art. 940210	CLIFFHANGER round, 100 mm	35 g
-------------	---------------------------	------



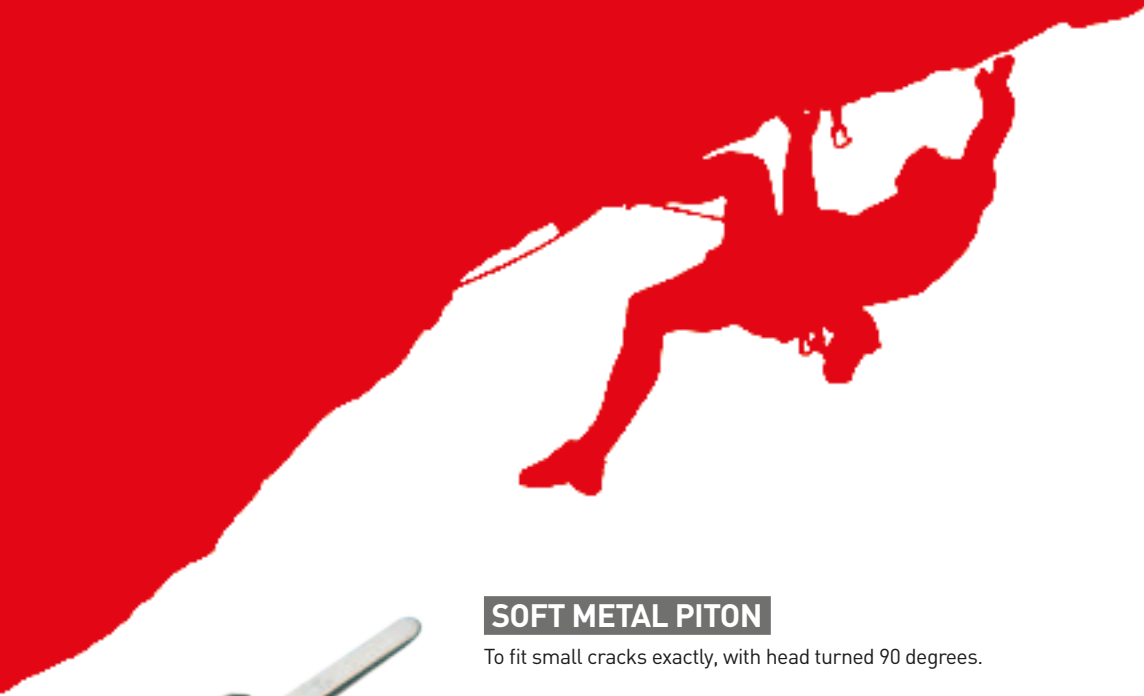

SOFT METAL PITON

To fit small cracks exactly, with head turned 90 degrees.

Art. 944009	SOFT METAL PITON, UL 50 mm (F)	80 g
Art. 944011	SOFT METAL PITON, UL 70 mm (F)	90 g
Art. 944013	SOFT METAL PITON, UL 90 mm (F)	110 g



RING PITON DIAGONAL

Head at 45 degrees, with loose ring for use in abseiling.

Art. 957013	RING PITON diagonal, UL 95 mm (F)	135 g
Art. 957015	RING PITON diagonal, UL 125 mm (F)	165 g



V-RING PITON

The V-shape makes this piton widen as it is forced into a crack. The ring is ideal for abseiling.

Art. 958016	V-RING PITON, UL 140 mm (S)	155 g
-------------	-----------------------------	-------



BOLT HANGER STANDARD

Made of stainless steel, EN 959 tested.

Art. 930510	BOLT HANGER STANDARD, 10 mm	38 g
Art. 930511	BOLT HANGER STANDARD, 12 mm	38 g



BOLT HANGER PROTECT

Similar to the Bolt Hanger Standard, but reduces the risk of damage to the karabiners with its bevelled hole flange. Made of stainless steel, EN 959 tested.

Art. 930610	BOLT HANGER PROTECT, 10 mm	40 g
Art. 930611	BOLT HANGER PROTECT, 12 mm	40 g



EXPANSION ANCHOR

Expansion anchor consisting of bolt, nut and washer. Made of A4 standard stainless steel.

Art. 930304	EXPANSION ANCHOR EXA 10/15 A4	M10 / 86 mm
Art. 930305	EXPANSION ANCHOR EXA 12/15 A4	M12 / 106 mm

CRAMPONS

Whether a 4-point standard or a 12-point crampon for extreme situations, our models have been expressly crafted to suit all your needs. Our wide range is carefully manufactured, and only from the best materials, naturally. Our slick heel lever is our response to the demands of the modern crampon-proof boot. **With the STUBAI STICK-ON anti-balling plates we have come up with a revolutionary, patented system to beat snow build-up – and it's the world's lightest!**

STUBAI®



STICK-ON ANTISTOLL



LIGHT **With integrated STICK-ON anti-balling system**

An extra-light, strong, tempered aluminium crampon with flexible bar and four available binding systems. By using the most modern technology, we have been able to combine minimal weight with maximum strength. Ideal for ski touring, winter climbing and for easier mountaineering tours. With its light weight and economy of space, the Light is at home in any rucksack.

Art. 922102	LIGHT CLASSIC, strap-binding, STICK-ON	590 g
Art. 922104	LIGHT UNIVERSAL, cradle-b., STICK-ON	630 g
Art. 922106	LIGHT COMBI, combi-binding, STICK-ON	680 g
Art. 922108	LIGHT PROFESSIONAL, lever-bind., STICK-ON	680 g



TWIN PEAKS **With integrated STICK-ON anti-balling system**

Short-toothed steel and aluminium crampons. By omitting front points, and combining low weight with 8 pairs of extremely effective points we have achieved an unusually high level of comfort and efficiency. Even totally inexperienced users, who feel unstable in other models, or who don't like front points, will have no problems at all with the STUBAI TWIN PEAKS. In fact, anyone who doesn't feel the need to climb sheer ice faces will like these crampons; whether you're a mountaineer, a hunter, or even a labourer. Also ideal for off-snow activities, walking on frozen-solid ground or mountain running.

Art. 922611	TWIN PEAKS CLASSIC, strap-bind., STICK-ON	705 g
Art. 922621	TWIN PEAKS UNIVERSAL, cradle-b., STICK-ON	745 g
Art. 922641	TWIN PEAKS LIGHT UNI, Alumi., cradle-b., STICK-ON	600 g



TREKKING **With integrated STICK-ON anti-balling system**

Classic 10-point, tempered steel crampon, with flexible bar, available with four different binding systems, for trekking or easy mountaineering. Very compact!

Art. 921902	TREKKING CLASSIC, strap-bind., STICK-ON	840 g
Art. 921904	TREKKING UNIVERSAL, cradle-b., STICK-ON	870 g
Art. 921906	TREKKING COMBI, combi-b., STICK-ON	930 g
Art. 921908	TREKKING PROFESSIONAL, lever-b., ST-ON	930 g



ANTISLIP

A small and extremely light crampon, for gaining grip in hard or slippery conditions. Ideal for spring tours when crossing tricky patches of old snow. Fits all shoe sizes

Art. 926510	ANTISLIP crampon, 4-point w. straps	280 g
Art. 926520	ANTISLIP crampon, 6-point w. straps	410 g



TIROL With integrated STICK-ON anti-balling system

12-point tempered steel mountaineering crampon with flexible bar, available with three different bindings. Crooked side points for safe traversing and horizontal front points to reduce the danger of slipping – especially useful on hard corned (firm) snow.

Art. 921100	TIROL UNIVERSAL, cradle-bind., STICK-ON	1005 g
Art. 921102	TIROL COMBI, combi-binding., STICK-ON	1065 g
Art. 921104	TIROL PROFESSIONAL, lever-b., STICK-ON	1065 g



SPECIAL EDITION! STUBAI WHITELINE With integrated STICK-ON anti-balling system

Technically identical to the standard model, but in a flash STUBAI-WHITELINE-LOOK finish.

Art. 921904WL	TREKKING UNIVERSAL, cradle-b., STICK-ON	870 g
Art. 921906WL	TREKKING COMBI, combi-b., STICK-ON	930 g
Art. 921908WL	TREKKING PROFESSIONAL, lever-b., STICK-ON	930 g
Art. 921100WL	TIROL UNIVERSAL, cradle-bind., STICK-ON	1005 g
Art. 921102WL	TIROL COMBI, combi-binding., STICK-ON	1065 g
Art. 921104WL	TIROL PROFESSIONAL, lever-b., STICK-ON	1065 g



X-CHANGE

The STUBAI X-Change – our complete all-rounder! Whether you want one or two front points, a flexible or rigid bar, a lightweight or solid crampon for competition or for fun – the X-Change system can do it all! With just a few turns, the heel- and frontpoints can be changed. For all-terrain mountaineers, this complete system removes the need for several pairs of specialized crampons, which saves both weight and space in your bag.

X-CHANGE PRO

- > rigid bar
- > perfect fit thanks to its crooked bar
- > front section can be tilted
- > adjustable and removable spur
- > interchangeable front points (mono- or duopoint)
- > professional binding with steel front bail and heel lever

Weight 1250 g

Art. 921401	X-CHANGE PRO crampon, modular	1250 g
-------------	-------------------------------	--------

X-CHANGE FLEX

The X-CHANGE FLEX has the same front as the X-CHANGE PRO, but the bar and heel of the TIROL model. The advantages of this are greater comfort, more space in your bag and fast adjustment – which makes it more versatile. The model is favoured by hire shops and ice-tower climbers alike.

- > flexible bar
- > interchangeable frontpoints (mono- or duopoint)
- > professional binding with steel front bail and heel lever

Weight 1110 g

Art. 921403	X-CHANGE FLEX crampon, modular	1110 g
-------------	--------------------------------	--------

CRAMPON ACCESSORIES

STUBAI®

PATENTED

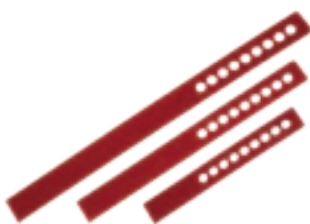

STICK-ON ANTISTOLL

STICK-ON AP

It's time for revolution! STUBAI presents the WORLD'S LIGHTEST ANTI-BALLING PLATE.

Does the thought of attaching an anti-balling plate fill your mind with horror at screws, hooks, stitches and even cables? That's history. Stone-age even. At STUBAI we simply stick it on – in seconds. Unpeel the back, press on, and, erm ... that's it! VIVA LA REVOLUCIÓN!

Art. 927011	STICK-ON ANTI-BALLING for Twin Peaks	40 g
Art. 927014	STICK-ON ANTI-BALLING for Trekking/Light	45 g
Art. 927016	STICK-ON ANTI-BALLING for Tirol	55 g
Art. 927019	STICK-ON ANTI-BALLING Plate, uncut, 3 plates with 30 x 12 cm each	100 g

3M VHB

Alcohol-based surface cleaner sachet to remove grease from your crampons before assembling the STUBAI STICK-ON anti-balling plates. Ensures perfect connection and long-life use.

Art. 929001	3M VHB Surface Cleaner Sachet	3 g
-------------	-------------------------------	-----

3M SCOTCH EASY-CLEAN-PEN

Cleaning Pen to easily remove sticky residue from your crampons. To be used when changing your STUBAI STICK-ON anti-balling plates.

Art. 929003	3M SCOTCH EASY-CLEAN-PEN quick cleaner	8,2 g
-------------	--	-------

CLASSIC AP

Prevent annoying and potentially dangerous build-up of snow and ice underneath the crampon between the points. Hard-wearing and cold-resistant.

Art. 927010	ANTI BALLING PLATE for Twin Peaks series	90 g
Art. 927013	ANTI BALLING PLATE for Trekking/Light series	125 g
Art. 927015	ANTI BALLING PLATE for Tirol series	155 g

FLEX BARS

Our models with flexible bar as standard, fit sizes EU 38-45 (except Tirol: 42-50). For smaller sizes (31-38, Tirol 35-42) or larger sizes (45-51, Tirol 50-56) we can provide a bar on request – at no extra cost!

CAUTION: The size of boot soles is not standardized, so we strongly recommend you fit your crampons before you buy.

Art. 921771	FLEX BAR for crampons	short
Art. 921772	FLEX BAR for crampons	standard
Art. 921773	FLEX BAR for crampons	long

TOE BAIL FASTENERS

Art. 921720	TOE BAIL FASTENERS f. professional-bindings
-------------	---

STRAPS

Art. 927002	STRAPS for crampons, p. pair	155 cm
Art. 927003	STRAPS for Antislip-crampons, p. pair	110 cm

POINT GUARDS

Rubber stoppers for crampon points to prevent damage to your rucksack and its contents.

Art. 927001	POINT GUARDS for crampons	12-point
-------------	---------------------------	----------

ICE AXES

STUBAI®

We have the right ice axe for every type of tour. STUBAI have developed an expertly balanced range for the many facets of mountaineering. All models are of course CE-approved and manufactured to the usual top STUBAI standards. So all models with a steel head meet the high requirements of category 'T' (technical axe). The lightweight axes with aluminium heads are certified according to type 'B' (basic axe).

PRO STAR

A modern-style axe for the professional. The gently crooked shaft is for precise application on steep slopes, but can still be used as an anchor point in snow. Both shaft and biting sharp pick are made to the highest possible standards.

Steel head
 Certification type T
 Weight 590-715 g

Art. 902352	PRO STAR ice axe, w/o gripper, w. wrist loop	52 cm	590 g
Art. 902359	PRO STAR ice axe, w/o gripper, w. wrist loop	59 cm	625 g
Art. 902366	PRO STAR ice axe, w/o gripper, w. wrist loop	66 cm	660 g
Art. 902373	PRO STAR ice axe, w/o gripper, w. wrist loop	73 cm	690 g

Art. 902252	PRO STAR ice axe, w. gripper, w. wrist loop	52 cm	615 g
Art. 902259	PRO STAR ice axe, w. gripper, w. wrist loop	59 cm	650 g
Art. 902266	PRO STAR ice axe, w. gripper, w. wrist loop	66 cm	665 g
Art. 902273	PRO STAR ice axe, w. gripper, w. wrist loop	73 cm	715 g



WHITE STAR

An excellent mountaineering all-rounder. Brilliant balance between the shaft and the forged steel head.

Steel head
 Certification type T
 Weight 595-750 g

Art. 904052	WHITE STAR ice axe, w/o gripper, w. wrist loop	52 cm	595 g
Art. 904059	WHITE STAR ice axe, w/o gripper, w. wrist loop	59 cm	630 g
Art. 904066	WHITE STAR ice axe, w/o gripper, w. wrist loop	66 cm	665 g
Art. 904073	WHITE STAR ice axe, w/o gripper, w. wrist loop	73 cm	695 g

Art. 904152	WHITE STAR ice axe, w. gripper, w. wrist loop	52 cm	620 g
Art. 904159	WHITE STAR ice axe, w. gripper, w. wrist loop	59 cm	655 g
Art. 904166	WHITE STAR ice axe, w. gripper, w. wrist loop	66 cm	690 g
Art. 904173	WHITE STAR ice axe, w. gripper, w. wrist loop	73 cm	720 g
Art. 904180	WHITE STAR ice axe, w. gripper, w. wrist loop	80 cm	750 g



IBEX

A lightweight glacier axe, with technically styled steel head.

Steel head
 Certification type T
 Weight 595-695 g

Art. 901252	IBEX ice axe, w. gripper, w. wrist loop	52 cm	595 g
Art. 901259	IBEX ice axe, w. gripper, w. wrist loop	59 cm	630 g
Art. 901266	IBEX ice axe, w. gripper, w. wrist loop	66 cm	665 g
Art. 901273	IBEX ice axe, w. gripper, w. wrist loop	73 cm	695 g





TOUR LITE TELESCOPE

A trekking axe with aluminium head and snow basket attached. Perfect for trekking and glacier walking. It's telescopic shaft can be adjusted according to preference from 60 to 95 cm.

Aluminium head
 Certification type B
 Weight 530 g

Art. 900799	TOUR LITE TELESCOPE, w. gripp., w. wrist loop	60-95 cm
-------------	---	----------



TOUR LITE

A touring axe with aluminium head, which despite its light weight, far exceeds European Standards for strength. With its strong shaft it can also be used as a 'dead man anchor'.

Aluminium head
 Certification type B
 Weight 395-495 g

Art. 900752	TOUR LITE ice axe, w. gripper, w. wrist loop	52 cm	395 g
Art. 900759	TOUR LITE ice axe, w. gripper, w. wrist loop	59 cm	430 g
Art. 900766	TOUR LITE ice axe, w. gripper, w. wrist loop	66 cm	465 g
Art. 900773	TOUR LITE ice axe, w. gripper, w. wrist loop	73 cm	495 g



Bergsteiger
TIPP
 Preis/Leistung.

02-2013

TOUR ULTRALIGHT

A top quality aluminium construction makes this the lightest in our range! An ideal partner for difficult passages over hard corn snow (firn) on ski tours.

Aluminium head
 Certification type B
 Weight 325-395 g

Art. 900152	TOUR ULTRALIGHT, w/o gripper, w. wrist loop	52 cm	325 g
Art. 900159	TOUR ULTRALIGHT, w/o gripper, w. wrist loop	59 cm	360 g
Art. 900166	TOUR ULTRALIGHT, w/o gripper, w. wrist loop	66 cm	395 g



ICE TOOLS



SCORPION

Our answer to the challenge of frozen waterfalls. The Scorpion excels with its fantastic balance and specially adapted shaft. The robust pick reduces ice splintering and purchases firmly. The head is interchangeable with pick, hammer and adze. Also equipped with a finger guard and an effective, easily detachable wrist loop.

Steel head
Certification type T
Length 48 cm
Weight 900 g

Art. 914610	SCORPION ice tool w. hammer head	48 cm	900 g
Art. 914611	SCORPION ice tool w. adze	48 cm	900 g



SCORPION BASIC

The extreme choice for steep ice faces and mountaineering. Uncompromising craftsmanship makes this an invaluable friend on the darkest north faces and on the world's highest mountains.

Steel head
Certification type T
Length 48 cm
Weight 710 g

Art. 914670	SCORPION BASIC ice tool w. hammer head	48 cm	710 g
Art. 914675	SCORPION BASIC ice tool w. adze	48 cm	710 g



HORNET PROTECT

The Hornet Protect is a great value ice tool for those new to the sport. With a gently curving shaft, a finger guard and a detachable wrist loop, this tool is gagging for steep ice – whether it's an ice tower or a frozen waterfall.

Steel head
Certification type T
Length 46 cm
Weight 690 g with adze, 710 g with hammer head

Art. 914740	HORNET PROTECT Eisgerät m. Flachschaufel	46 cm	690 g
Art. 914750	HORNET PROTECT Eisgerät m. Hammerkopf	46 cm	710 g



HORNET

Great value tool for use in extreme mountain and icy conditions. The Hornet's assets are that it is simple, reliable and light – which makes it great for beginners.

Steel head
Certification type T
Length 46 cm
Weight 600 g with adze, 620 g with hammer head

Art. 914710	HORNET ice tool w. adze	46 cm	600 g
Art. 914720	HORNET ice tool w. hammer head	46 cm	620 g

ICE AXE / ICE TOOL ACCESSORIES

Although sharp points and teeth are essential at the ice-face, they can also make an obvious and unnecessary nuisance of themselves elsewhere. Our accessories can help make your spikes safer.

STUBAI®



WRIST LOOP

Art. 919003 WRIST LOOP for ice axes, with ring



ICE AXE HEAD COVER

Rubber cover to protect the adze and pick of your ice axe.

Art. 919006 ICE AXE HEAD COVER



POINT GUARD

All our ice axes and ice tools (except the Tour Lite Telescope) are delivered with a POINT GUARD. It helps to avoid unnecessary damage.

Art. 919010 POINT GUARD triangle, for ice axes



INTERCHANGEABLE SYSTEM

The Scorpion ice axe has an interchangeable head system for hammer, adze and pick. These parts can, of course, also be ordered individually.

Art. 914615	SCORPION STEEP ICE PICK	150 g
Art. 914620	SCORPION HAMMER HEAD	75 g
Art. 914621	SCORPION ADZE	75 g
Art. 914650	SCORPION WRIST LOOP	65 g

ICE SCREWS

STUBAI ice screws are famous for their excellent bite, their speed of engagement, and their special finish, which makes it easier to remove the core.

STUBAI®



SIGMA II

An ice screw with very strong steel shaft and hardened 4-toothed drill bit. Tempered steel handle.

Weight 135, 155 and 175 g

Art. 963911	SIGMA II ice screw with steel handle	120 mm
Art. 963913	SIGMA II ice screw with steel handle	170 mm
Art. 963915	SIGMA II ice screw with steel handle	220 mm



SIGMA II PLUS

An ice screw with very strong steel shaft and hardened 4-toothed drill bit. Tempered steel handle and a built-in crank for even quicker application.

Weight 165, 185 and 205 g

Art. 963921	SIGMA II PLUS ice screw w. steel handle+crank	120 mm
Art. 963923	SIGMA II PLUS ice screw w. steel handle+crank	170 mm
Art. 963925	SIGMA II PLUS ice screw w. steel handle+crank	220 mm



SIGMA X-PRESS

A short ice screw with steel handle for tackling thinner ice sheets. CAUTION: Does not conform to EN, is not CE-tested!

Weight 75 g

Art. 963931	SIGMA X-PRESS short ice screw w. steel handle	80 mm
-------------	---	-------



AVALANCHE SAFETY

STUBAI®

STUBAI AVALANCHE SAFETY PRODUCTS are an indispensable part of your gear on any snow tour. Our shovels are made exclusively from highest quality aluminium and will perform in even the most desperate conditions. We also offer a full range of avalanche probes. From the super lightweight STUBAI CARBON RAPID to the almost indestructible STUBAI NIRO RESCUE.



TECBLADE

Every model in the STUBAI TECBLADE series has the following features:

- > QUICK LINK SYSTEM for speedy assembling
- > GRIP STRIPS and OVAL SHAFT for perfect handling
- > AXE FUNCTION for compact snow and rutsch block tests
- > SMALL PACK SIZE due to the integrated blade and handle socket
- > SPECIAL NOTCHES for rescue- and secure techniques
- > TOP QUALITY ALUMINIUM ALLOY for great durability
- > FLATTENED TREAD to stop your boots slipping when kicking the blade in
- > BEVELED BLADE for easier digging
- > HANDLE CAPS to stop snow getting into the shaft



QUICK-LINK-SYSTEM

TECBLADE MINI

An ideal piece of kit for people who want their packs lighter and more compact, but will not compromise on quality or performance. The seat for the solid shaft is integrated into the blade to save space.

Weight 635 g
Size of blade 22,50 x 26 cm
Working length 67 cm

Art. 996307	TECBLADE MINI avalanche shovel w. T-handle	635 g
-------------	--	-------

TECBLADE LOOP

Top quality shovel with radical new Loop-handle! Because the handstrap is fastened to the T-grip you don't have to hold the handle that firmly, saving energy when lifting. In contrast to D-shaped handles, the loop just weights a couple of grammes and takes up practically no space. The TECBLADE LOOP also has a telescopic oval shaft, with ribbed grip and Quick-link system for speedy assembly.

Weight 775 g
Size of blade 22,50 x 26 cm
Working length 92 cm

Art. 996309	TECBLADE LOOP avalanche sh. w. Loop-handle	775 g
-------------	--	-------

TECBLADE PRO

Avalanche shovel with extra large blade and surface area for professional use. Designed for organized avalanche rescues where shovel capacity and quality are paramount. Equipped with the innovative STUBAI-LOOP grip system, with telescopic oval shaft.

Weight 845 g
Size of blade 27,50 x 26 cm
Working length 91 cm

Art. 996311	TECBLADE PRO avalanche sh. w. Loop-handle	845 g
-------------	---	-------

FEATURES AND HANDLING

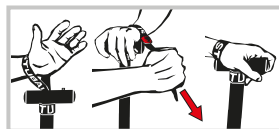

1. THE LOOP
An innovative handle enhancement! It gives you better leverage, eliminates slipping, and because you can use it hands free, you don't have to waste time taking it off to look for your beeper. All this with negligible impact on the space and weight in your bag. Comes as standard with the TB LOOP or TB PRO model, and available as an accessory to all other models.

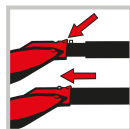

2. QUICK LINK
Speedy assembly with the self-guiding Springpins.



3. GRIP STRIPS
Glove-friendly anti-slip rubber for perfect grip.



4. HANDLE CAPS
Stop snow getting into the shaft and handle.



5. AXE FUNCTION
For use against very compact snow (leg for snow profiling and for rutsch block tests)



6. COMPACT
Handle socket integrated into the blade for space-efficiency.

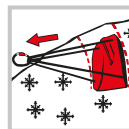

7. SNOW ANCHOR
Special notches for using your shovel in this securing technique.

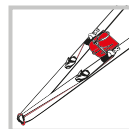

8. IMPROVISED SLED
For the improvised removal of wounded from the scene (built also from touring equipment and standard bag contents).



COMPACT

Very compact avalanche shovel, which can be speedily adjusted to three different positions:

1. folded
2. as a pick
3. or as a shovel

Its reliability and small size make it especially popular on expeditions!

Weight 610 g
 Size of blade 20 x 23 cm
 Working length 60 cm
 Packing size (folded) 40 cm

Art. 996201	COMPACT avalanche shovel with T-handle	610 g
-------------	--	-------



STUBAI-LOOP

The innovative STUBAI-LOOP grip system is as simple as it is ingenious – an adjustable handstrap fastened to a T-grip handle offers numerous advantages over conventional products – and all without any significant impact on your pack-space or weight:

- > Energy-saving extra leverage
- > No more accidental slipping
- > Effortless application
- > Hands free instantly without having to drop the shovel

The STUBAI-LOOP fits any STUBAI TECBLADE (even the older models!)

Weight 14 g

Art. 950099	LOOP wristloop for avalanche shovels	14 g
-------------	--------------------------------------	------



CARBON RAPID

Extremely light avalanche probe with depth markings. Uses a simple pull-cord system for assembly which saves valuable time when you need it most. The mainly carbon structure in combination with aluminium means high stability and amazingly light weight. Ideal when every gramme counts. Bag included.

Weight 195 g
 Packing size 45 cm
 Length 265 cm

Art. 911415	CARBON RAPID avalanche probe 265 cm	195 g
-------------	-------------------------------------	-------



ALU RAPID

The Classic – a good value probe with depth markings, made from aluminium alloy. Uses a simple pull-cord system for assembly which saves valuable time when you need it most. Bag included.

Weight 215 g
 Packing size 45 cm
 Length 265 cm

Art. 911425	ALU RAPID avalanche probe 265 cm	215 g
-------------	----------------------------------	-------



NIRO RESCUE

An avalanche probe for professional rescue teams made from durable stainless steel. With quick-release assembly system the probe can quickly be lengthened to 250 cm. For use in deeper snow three 50 cm extensions are included, which can be easily added when required. Bag included.

Weight 990 g
 Packing size 55 cm
 Length 400 cm (250 cm + 3 extensions included)

Art. 911455	NIRO RESCUE avalanche probe 250-400 cm	990 g
-------------	--	-------

STEEL KARABINERS

STUBAI®

STUBAI is one of the world's leading steel karabiner manufacturers. We are proud that every day people the world over put their trust in the quality of our products. Our precision manufacturing processes and strict quality controls are all geared to your safety!



SUPER 5000

Our strongest!

Material forged steel, galvanized
 ◇ 50 kN ◇ 10 kN ↻ 35 kN ↻ 15 mm
 Weight 245 g
 Exterior dimensions 116 x 60 mm
 According to EN 362, EN 12275, UIAA 121

Art. 978001	SUPER 5000 steel karabiner, forged, galv.	50 kN
-------------	---	-------



ASYM. OVAL

Material steel
 ◇ 30 kN ◇ 9 kN ↻ 8 kN ↻ 21 mm
 Weight 240 g
 Exterior dimensions 120 x 63 mm
 According to EN 362, EN 12275, UIAA 121

Art. 982002	ASYM. OVAL steel karabiner, galvanized	30 kN
Art. 982041	ASYM. OVAL steel karabiner, KTL, black	30 kN



OVAL

Material steel, galvanized
 ◇ 25 kN ◇ 9 kN ↻ 8 kN ↻ 21 mm
 Weight 240 g
 Exterior dimensions 122 x 63 mm
 According to EN 362, EN 12275, UIAA 121

Art. 982003	OVAL steel karabiner, galvanized	25 kN
-------------	----------------------------------	-------



OVAL 40 kN

Material steel, galvanized
 ◇ 40 kN ◇ 12 kN ↻ 15 kN ↻ 27 mm
 Weight 305 g
 Exterior dimensions 130 x 72 mm
 According to EN 362, EN 12275, UIAA 121

Art. 982501	OVAL 40 kN steel karabiner, galvanized	40 kN
-------------	--	-------



ASYM. D-FORM

Material steel
 ◇ 34 kN ◇ 10 kN ↻ 10 kN ↻ 26 mm
 Weight 228 g
 Exterior dimensions 112 x 71 mm
 According to EN 362, EN 12275, UIAA 121

Art. 985001	ASYM. D-FORM steel karab., galvanized, silver	34 kN
Art. 985041	ASYM. D-FORM steel karab., KTL, black	34 kN



HMS

Material steel, galvanized
 ◇ 25 kN ◇ 10 kN ⤵ 8 kN ⤵ 25 mm
 Weight 223 g
 Exterior dimensions 109 x 72 mm
 According to EN 362, EN 12275, UIAA 121

Art. 987701	HMS steel karabiner, galvanized	25 kN
-------------	---------------------------------	-------

FIREMANS KARABINER SCREW

Material forged steel, galvanized
 ◇ 20 kN ⤵ 28 mm
 Weight 368 g
 Exterior dimensions 140 x 85 mm
 According to EN 362

Art. 488501	FIREMANS steel karabiner w. safety pin	20 kN
-------------	--	-------

FIREMANS KARABINER

Material forged steel, galvanized
 ◇ 15 kN ⤵ 51 mm
 Weight 925 g
 Exterior dimensions 210 x 108 mm
 According to ÖN F4031

Art. 488601	FIREMANS steel karabiner w. belt ring	15 kN
-------------	---------------------------------------	-------



APPAREL

STUBAI®

ETERNAL

STUBAI ETERNAL sports gloves are extra light and extremely comfortable. They are especially effective when your hands need protection in relatively warm temperatures. The mesh on the back of the hand is made of breathable fabric, and the palms have been specially reinforced. They make the STUBAI ETERNAL wear-and-slip-resistant and give you some welcome padding. The elastic wrist strap with Velcro fastener ensures a snug fit.

The ETERNAL ¾ FINGER with its free finger tips gives you maximum sensitivity and has been designed with Via Ferrata and biking in mind. The ETERNAL FULL FINGER is perfect for early and late season activities – like mountain and ski tours and for abseiling and ice climbing.



Art. S950069	ETERNAL FULL FINGER-SET: 2 x S, 3 x M, 4 x L, 3 x XL	12-pcs
Art. 950062	ETERNAL FULL FINGER Gloves	S
Art. 950063	ETERNAL FULL FINGER Gloves	M
Art. 950064	ETERNAL FULL FINGER Gloves	L
Art. 950065	ETERNAL FULL FINGER Gloves	XL

Art. S950079	ETERNAL ¾ FINGER-SET: 2 x S, 3 x M, 4 x L, 3 x XL	12-pcs
Art. 950072	ETERNAL ¾ FINGER Gloves	S
Art. 950073	ETERNAL ¾ FINGER Gloves	M
Art. 950074	ETERNAL ¾ FINGER Gloves	L
Art. 950075	ETERNAL ¾ FINGER Gloves	XL



WHITELINE BASEBALL CAP

Cool looking Baseball cap with stretchy headband for a perfect fit.

Material 100% Cotton

Art. 950050	WHITELINE Baseball cap	Unize
-------------	------------------------	-------

WHITELINE BEANIE

Keep your head and ears warm with the Stubai Whiteline Beanie. Made from stretchy soft acrylic for a perfect fit.

Material 100% Soft acrylic

Art. 950053	WHITELINE Beanie	Unize
-------------	------------------	-------

WHITELINE POLO

The perfect combination of style and sport. The STUBAI WHITELINE poloshirt is easy to wear and looks flash too! Available in both men's and ladies' sizes

Material 96% Cotton, 4% Lycra

Art. 950036	WHITELINE Poloshirt Women	36
Art. 950037	WHITELINE Poloshirt Women	38
Art. 950038	WHITELINE Poloshirt Women	40
Art. 950031	WHITELINE Poloshirt	S
Art. 950032	WHITELINE Poloshirt	M
Art. 950033	WHITELINE Poloshirt	L
Art. 950034	WHITELINE Poloshirt	XL

WHITELINE T-SHIRT

For sports or casual wear, the STUBAI WHITELINE T-SHIRT is both stylish and extra dry. The super light breathable microfibre material is nicely soft to the touch. It is just at home in the summer heat as it is on a rockface or mountain peak.

Material 100% Polyester

Art. 950041	WHITELINE T-Shirt	S
Art. 950042	WHITELINE T-Shirt	M
Art. 950043	WHITELINE T-Shirt	L
Art. 950044	WHITELINE T-Shirt	XL

SKYSPORTS / BUCKLES



CLICK FIX FLEX

Tempered aluminium buckle with black anodized finish and steel adjustment plate. For belts up to 45 mm width.

Strength 24 kN

Weight 98 g

Art. 971603	CLICK FIX buckle adjustable, anod.	24 kN
-------------	------------------------------------	-------



CLICK FIX FLEX XL

Similar to the CLICK FIX FLEX but with extra large openers.

Strength 24 kN

Weight 105 g

Art. 971605	CLICK FIX XL buckle adjustable, anod.	24 kN
-------------	---------------------------------------	-------



CLICK FIX

Tempered aluminium buckle with black anodized finish. For belts up to 45 mm width.

Strength 24 kN

Weight 70 g

Art. 971503	CLICK FIX buckle non-adjustable, anod.	24 kN
-------------	--	-------



CLAW FIX

New claw buckle which prevents accidental opening under pressure. The opening levers can only be engaged by squeezing the buckles to release the clasp. Made from tempered aluminium with a black anodized finish. For belt widths of up to 45 mm.

Strength 24 kN

Weight 75 g (CLAW FIX XL), 105 g (CLAW FIX FLEX XL)

Art. 971545	CLAW FIX XL buckle non-adjustable, anod. 45 mm	24 kN
Art. 971645	CLAW FIX FLEX XL buckle adjustable, anod. 45 mm	24 kN

CLAW-SYSTEM



MINIFLY PRO

Tempered aluminium screw-gate karabiner for securing flight strings. CAUTION: Do not use for climbing!

Strength 8 kN

Weight 10 g

Art. 970321	MINIFLY PRO karabiner, polished	8 kN
-------------	---------------------------------	------



SPACE CLIP

STUBAI®

The SPACE CLIP storage solution system is as ingenious as it is simple. It creates space and order in any room quickly and easily – whether it's your ski room, your store room, your business or your garage.

- > Clip can hold practically anything (skis, snowboard, cross-country skis, ice axe, avalanche shovel, skateboard, broom, garden tools and much more)
- > Simple one-handed usage
- > Clean and secure storage
- > Brings order to your garage, cellar, warehouse, counter and much more.
- > Ideal for product presentation in salesrooms and showrooms
- > Elegant and solid design
- > Easy installation

SPACE CLIP UNIVERSAL

Storage solution system for wall mounting. You can screw it directly into the wall, but it's best fitted to the special aluminium rail mount (Article no 499811BS). You can slide up to 5 Space Clips on this 1m rail, but a line of rails can be any length you like!



Maximum opening 27 mm
Perfect handling with products up to 25 mm
Weight 245 g

Art. 499810BS	SPACE CLIP Universal clip, black-yellow	245 g
Art. 499811BS	SPACE CLIP Aluminium Rail Mount	1 m, 580 g

SPACE CLIP SET

3-in-one set with the ingenious universal SPACE CLIP mounted on an aluminium rail! Simply screw on to the wall, and create instant order in your world! Screws and wall plugs included.



Maximum opening 27 mm
Perfect handling with products up to 25 mm
Length 50 cm
Weight 805 g

Art. 499813BS	SPACE CLIP 3-in-one set, black-white	50 cm
---------------	--------------------------------------	-------

FEATURES AND HANDLING

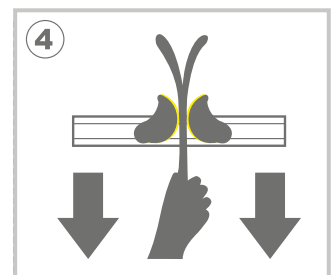
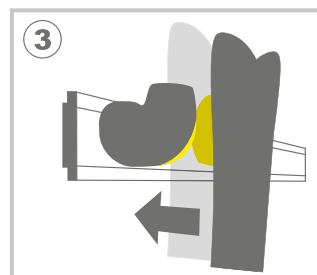
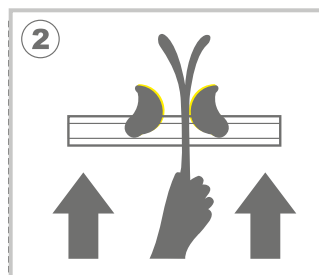
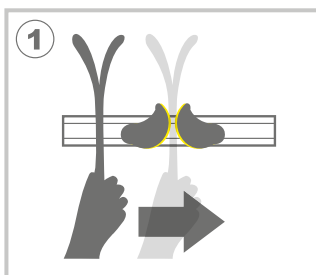



IMPRINT

EDITOR:
Stubai ZMV GMBH, 6166 Fulpmes/Austria.

CONCEPT AND CONSULTANTS:
Helmut Knoflach, Edward Ward,
Werner Niederkircher.

GRAPHIC & DESIGN:
Werner Niederkircher, Innsbruck/Austria,
www.nuovoline.at

ILLUSTRATIONS:
Gregor Nedl, Innsbruck/Austria, BOS,
Innsbruck/Austria.

PHOTOS:
Wolfgang Thomaseth, Thor André F.
Haadem, Christian Steinlechner, Michael
Gorczyca, Daniel Horvath, Archiv Stubai, Alex
Nuding, Werner Niederkircher, Fotolia.

PHOTO CREDITS:
COVERPHOTO: Matthias Knaus, Geitgaljen
(1.085 m), Lofoten/Norway. Pic: Wolfgang
Thomaseth.

PAGE 2: Raymond Sundvold, Hurrungane/
Norway. Pic: Thor André F. Haadem.

PAGE 4: Daniel „Dalton“ Horvath,
Marjan-Split/Croatia, Route U2.

Pic: Christian „Stoanmandl“ Steinlechner.
PAGE 31: Headquarters STUBAI ZMV GMBH/
Österreich. Pic: Michael Gorczyca.

PAGE 32: Stubai on the Rocks, Croatia.
Pic: Daniel „Dalton“ Horvath.

PRINT:
Druckerei Aschenbrenner,
6330 Kufstein/Austria.

Technical specifications may change without
notice. Mistakes, misprints and typographical
errors excepted.

Printed on environmentally-friendly,
chlorinefree bleached paper.

Images are not to scale.

The standard sales and delivery
terms of Stubai ZMV GMBH,
6166 Fulpmes/Austria apply.

Valid until further notice or until new
workbook coming into force.

© 2013 EDITION 2
Stubai ZMV GMBH



Stubai ZMV GMBH
Dr. Köfler Strasse 1
6166 Fulpmes
Austria
T +43 (0)5225 6960-0
F +43 (0)5225 6960-12
office@stubai.com

www.stubai-bergsport.com

